

15926-703.00

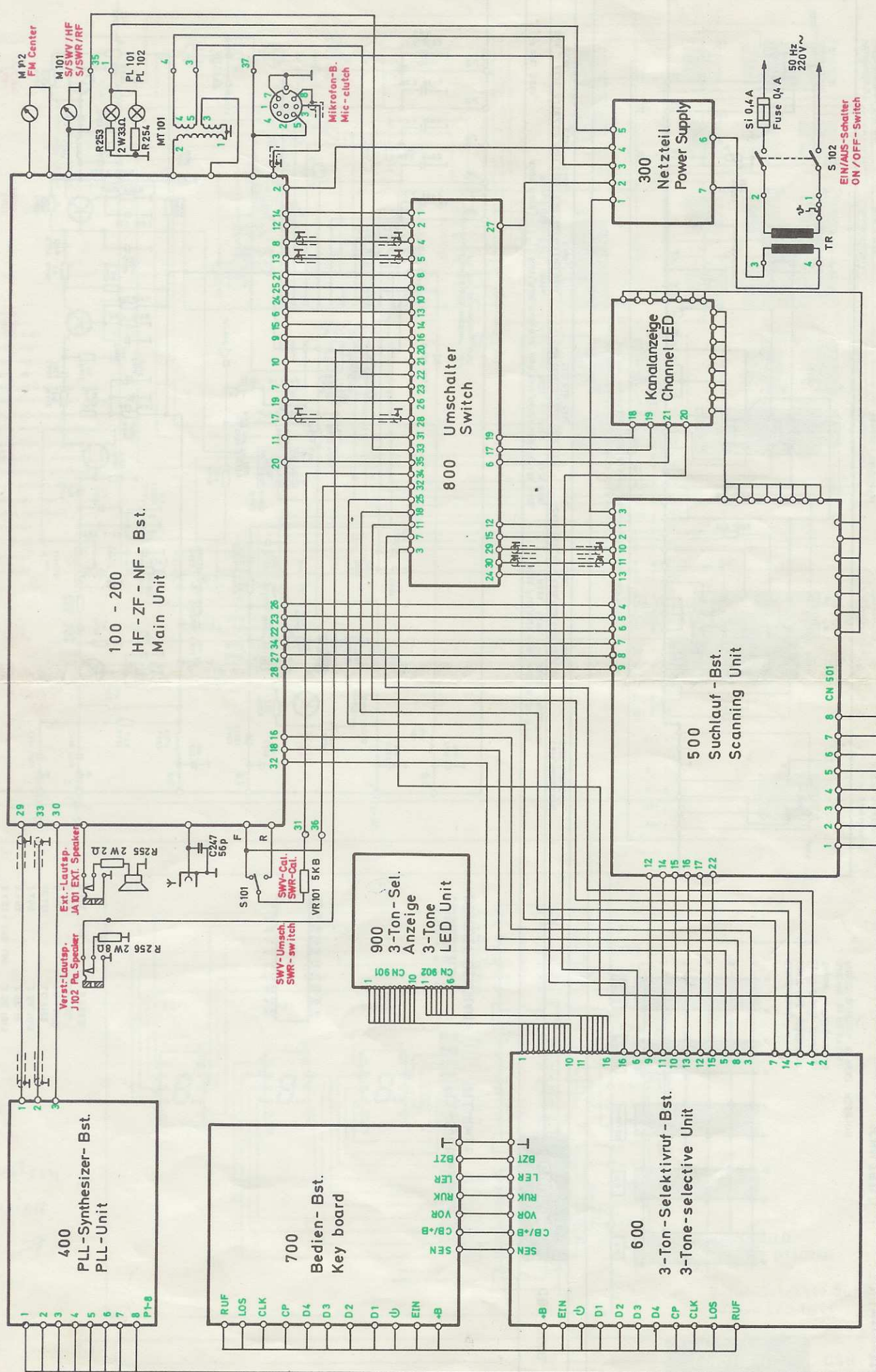

BLOCKSCHALTBILD
BLOCK DIAGRAM

T 401 - 403, 405 2 SC 1815
T 404 2 SK 19
T 406 2 SA 1015
JC 401 LC 7122
D 401 1S 2689
D 402 SVC 251
D 403 - 406 1S 1555

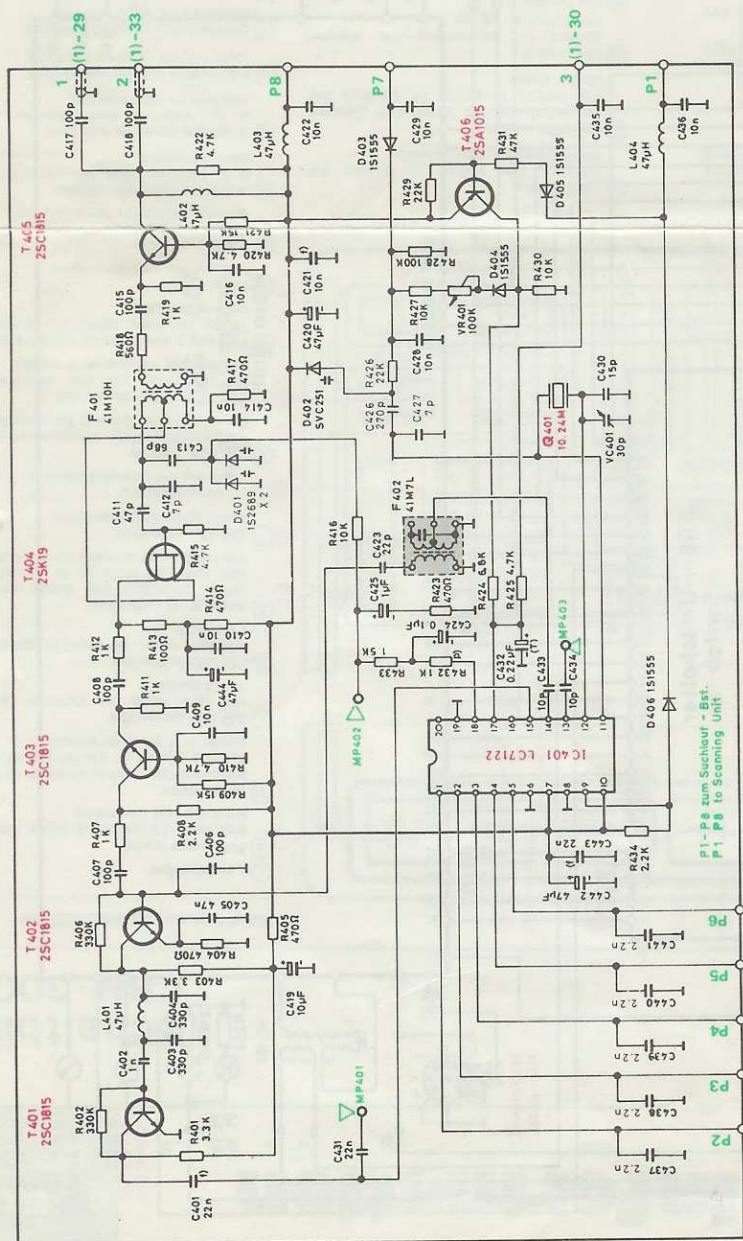

SCHALTBILD
CIRCUIT DIAGRAM

PLL-Synthesizer
PLL-Unit

GRUNDIG

CBH 3000

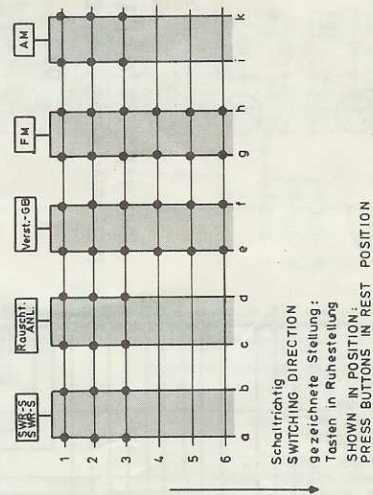

SCHALTBILD
CIRCUIT DIAGRAM

Umschalter
Switches

GRUNDIG

CBH 3000

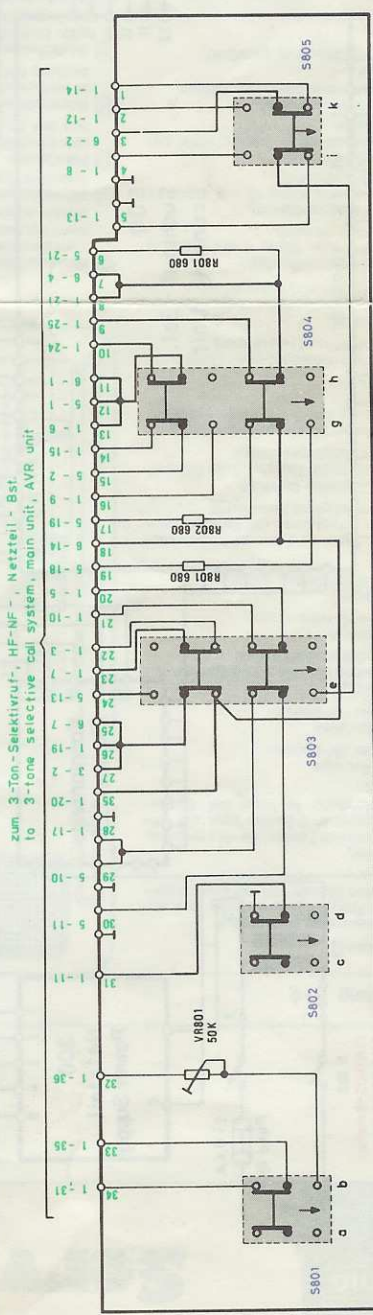

AM Umschalter
AM selector

FM Umschalter
FM selector

Umschalter
Sender - Verstärker
Selector switch
Transmitter-Amplifier

Umschalter:
SWR-Messen - S-Meter
Selection: response
SWR measuring - S-meter

R:

C:

SCHALTBILD
CIRCUIT DIAGRAM
3-Ton-Selektiv-Ruf-Anzeige
3-Tone LED Unit

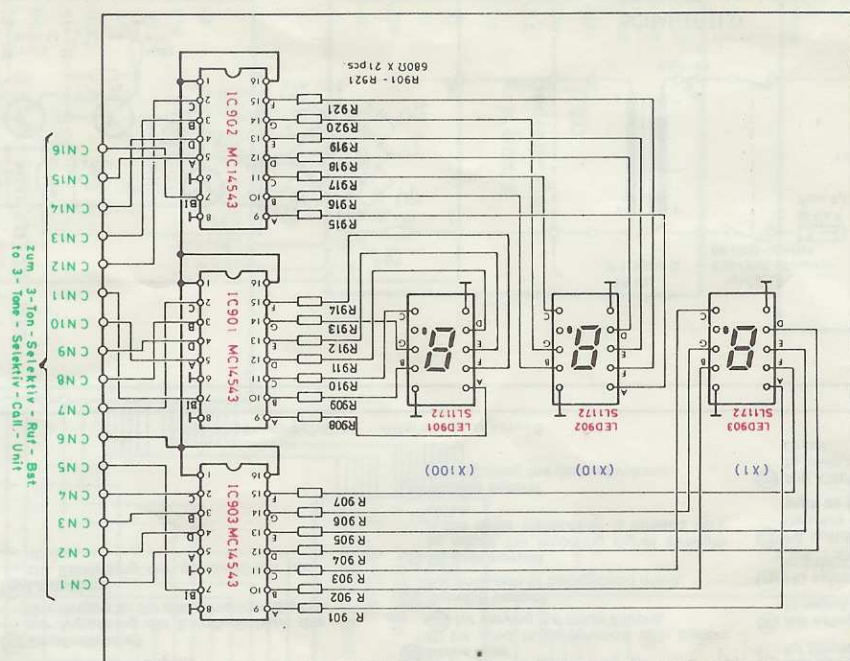

←
komplett
Baustein

Bedientell
Key Board Unit

SCHALTBILD
CIRCUIT DIAGRAM

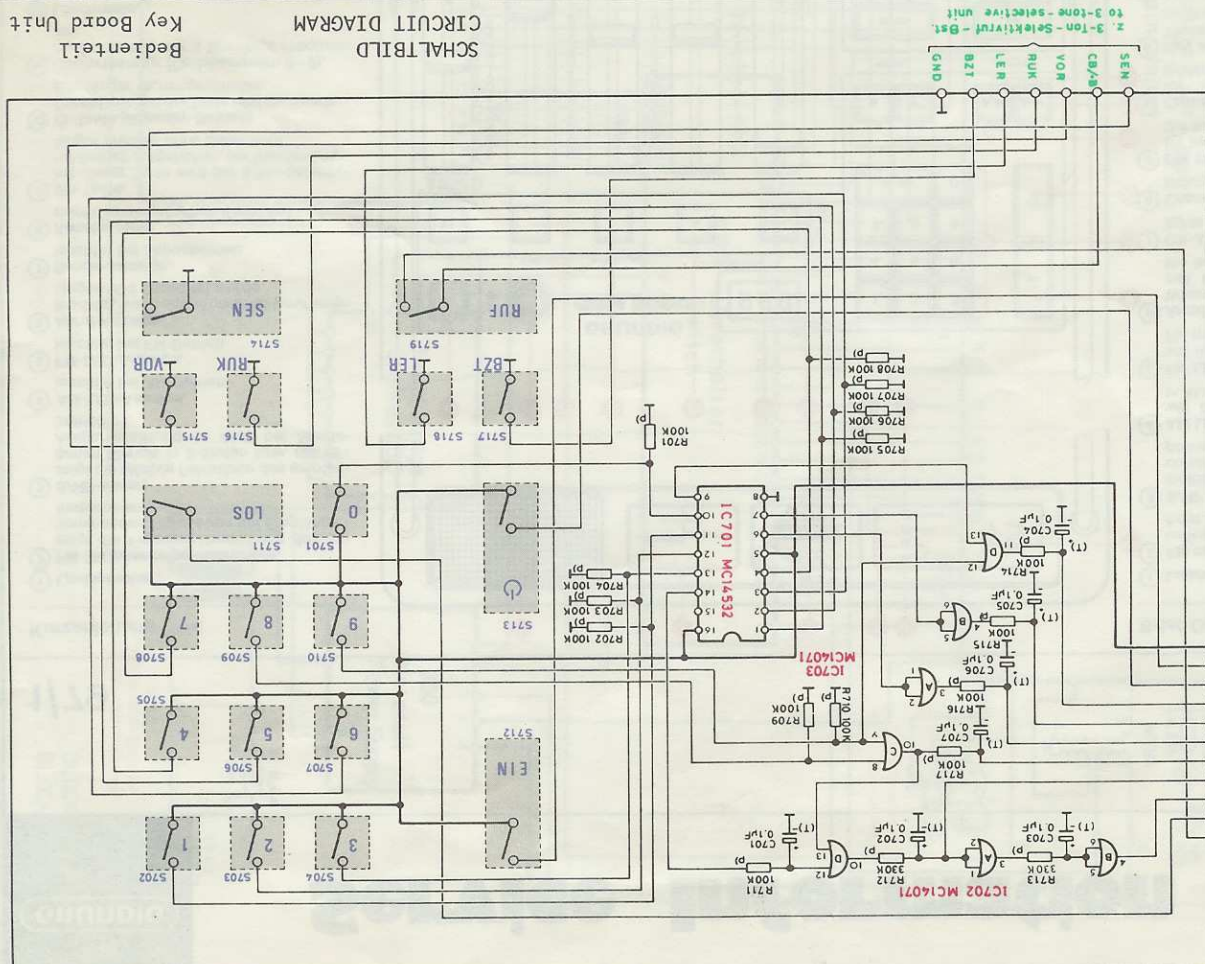

EIN = "Standby AUS"	
Ü = "Standby EIN"	
ON = "Standby ON"	
127 = "Suchkanal für besetzten Kanal"	
" = "Suchkanal für besetzten Kanal"	
ER = "suchtbesetzte RUF-freier Kanal"	
RUK = "Kanalmitliste - abwärtsziehend"	
" = "Channelmaster - downwards"	
" = "Kanalmaster - aufwärtsziehend"	
RUF = "Selektiver RUF"	
" = "Selective call button"	
SEN = "Sendeleiste"	
" = "Push-to-talk button"	
LOS = "Lockleiste"	
" = "Clear Key"	

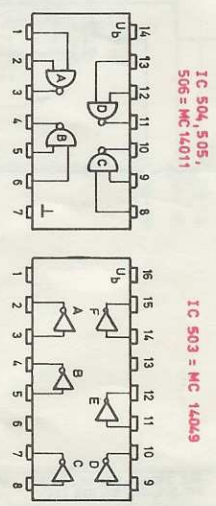

LED 502...
LED 505 = 4 x SLP - 132 B

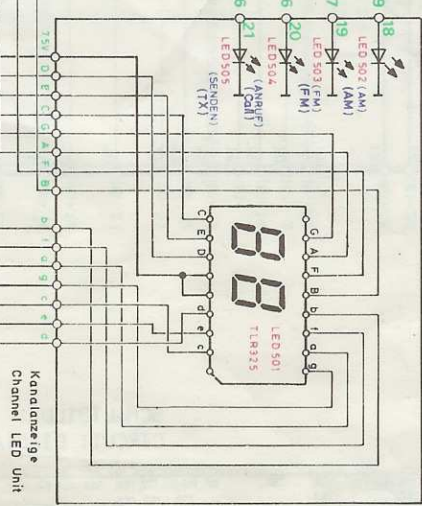

Kanalanzeige
Channel LED Unit

SCHALTBILO CIRCUIT DIAGRAM

Suchlauf-Baustein + Kanal-Anzeige
Scanning-Unit + Channel LED Unit

R:	R 502, R 503,	R 504, R 501, R 506,	R 507, R 518,	R 519, R 520,	R 523, R 524,	R 526, R 522,	R 511, R 514, R 515,
C:	C 502, C 503,	C 504, C 506, C 501, C 517, C 507,	C 519, C 514, C 511, C 512,	C 515, C 516,	C 510,	C 510,	C 510

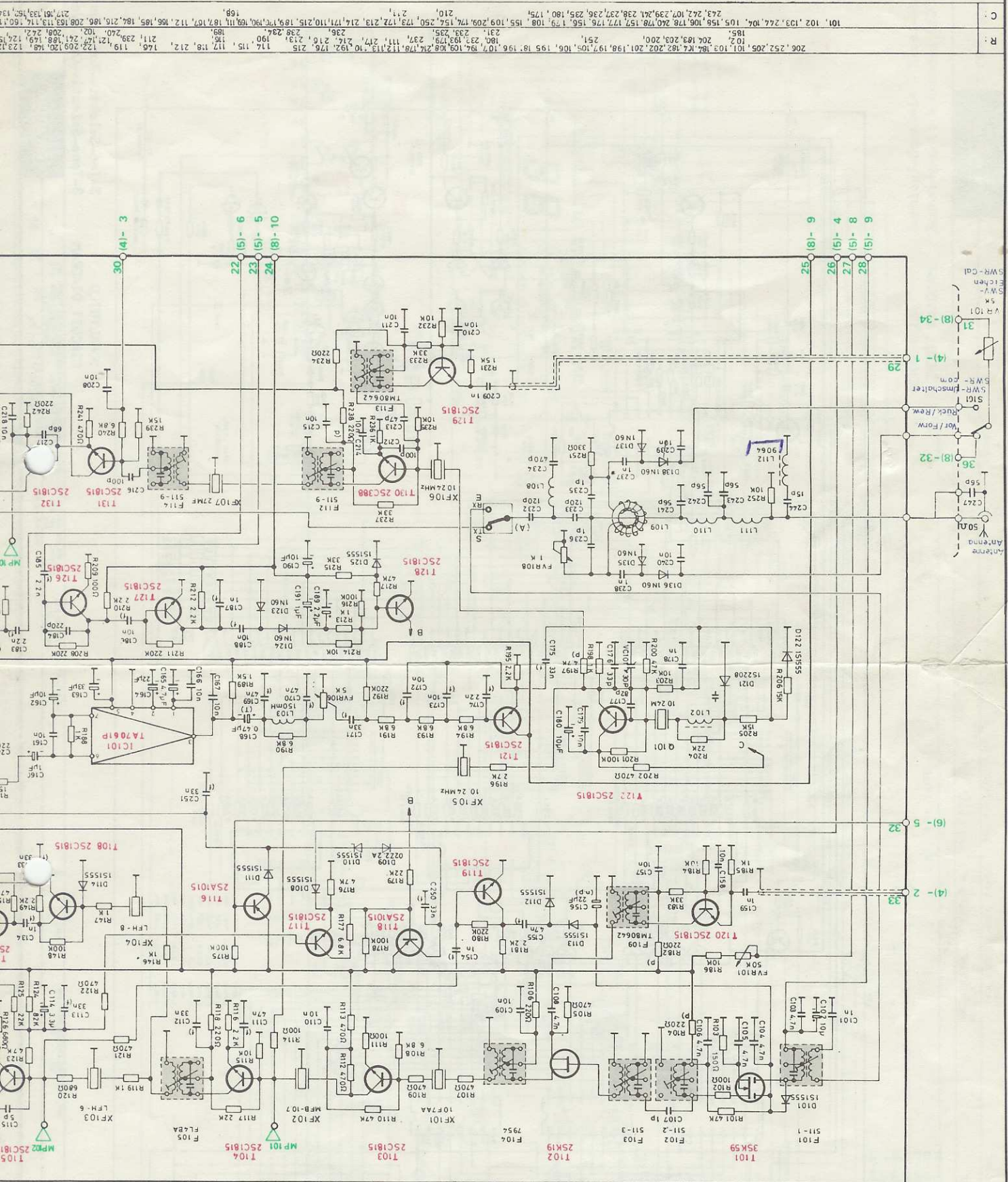

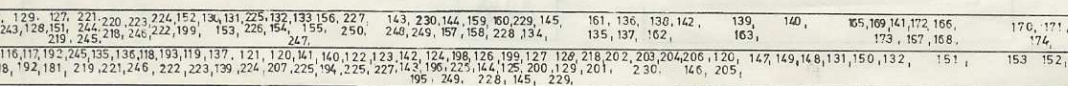

HF-/ZF-und NF-Baustein
RF-/IF-und AF-Unit